



- Place the large or small composite cup with built-in spring over the cone and lock it in place with the combination spacer/nut and you are ready to machine. (The size of the composite cup must match the size of the backing plate used in step 2.)



### How to use the AP-System for Light and Medium Trucks:

- Secure the hubless adaptor with the locator in place on the arbor. Slide the truck backing plate over the locator.



- Slide the truck drum or rotor over the hubless adaptor on the lathe.



- Secure the cone in place with the combination spacer/nut and you are ready to begin machining.



**GOODTOOL**  
 Brake Service Tools and Supplies  
 156 Galewski Drive • P.O. Box 70 • Winona, MN 55987-0070  
 1-800-880-7121 • Phone 507-454-1454 • Fax 507-454-1471  
 visit us on the web at: [www.goodtool-online.com](http://www.goodtool-online.com)

# AP-4800 / AP-4900 AP-5000 / AP-6000 / AP-9000 Instructions



**GOODTOOL**  
 Brake Service Tools and Supplies  
 156 Galewski Drive • P.O. Box 70 • Winona, MN 55987-0070  
 1-800-880-7121 • Phone 507-454-1454 • Fax 507-454-1471  
 visit us on the web at: [www.goodtool-online.com](http://www.goodtool-online.com)

# AP-SYSTEM

**Please read instructions before using.**

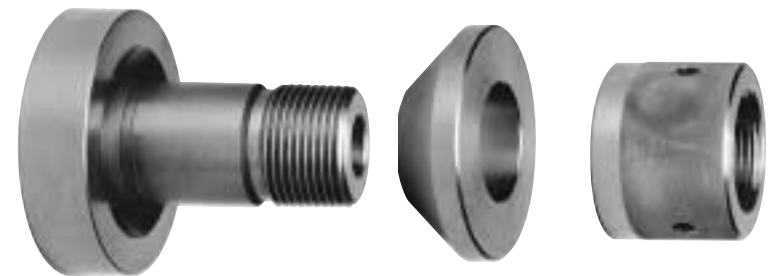

The AP-System (hubless adaptor system) contains a locator, centering cone, combination spacer and locking nut, and spanner wrench. For demonstrating purposes, we'll use a two inch spacer, a one inch spacer and an arbor nut, which are not included in the kit, but are available accessories.



**1.** The locator is mounted on the one inch arbor.



**2.** The one inch and the two inch spacers are put into place.



**3.** Then the nut goes on, tightening the locator in place.



**4.** Next, the rotor is put on, followed by the cone, which automatically centers the rotor. This one cone will work in almost all applications.



**5.** The combination spacer/ locking nut is put on and the spanner wrench from the kit is used to tighten it.

### Final Note

Once the rotor is adequately secured, you are ready to begin machining. The Goodtool AP-System will work on any manufacturer's one inch arbor.



### How to use the AP-System for Drums:

**1.** Place the hubless adaptor with the locator in place on the arbor. Slide the large or small backing plate over the locator.



**2.** Slide the drum on the lathe over the hubless adaptor. Place the cone into the center hole of the drum.

For drums with thick in-walls, you may want to use only the center cone and spacer/nut to secure the drum in place.



**3.** For drums with thin in-walls, place the large or small composite cup with built-in spring over the cone for additional support and lock it into place with the combination spacer/nut. (The size of the nut must match the size of the backing plate used in Step 1.)



### How to use the AP-System for Composite Rotors:

**1.** Place the hubless adaptor with the locator in place on the arbor. Slide the large or small backing plate over the locator.

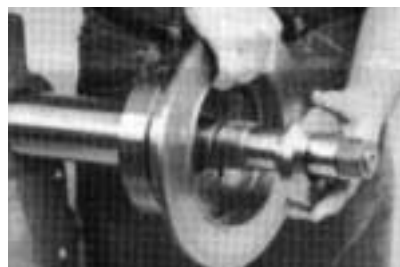

**2.** Slide the composite rotor on the lathe followed by the cone from the hubless adaptor.

(continued on next page)