



GOODTOOL

Brake Service Tools and Supplies

156 Galewski Drive • P.O. Box 70 • Winona, MN 55987-0070

1-800-880-7121 • Phone 507-454-1454 • Fax 507-454-1471

visit us on the web at: www.goodtool-online.com

DECIMALS MILLIMETERS

$\frac{1}{64}$.015625	—	0.397
$\frac{1}{32}$.03125	—	0.794
$\frac{3}{64}$.046875	—	1.191
$\frac{1}{16}$.0625	—	1.588
$\frac{5}{64}$.078125	—	1.984
$\frac{3}{32}$.09375	—	2.381
$\frac{7}{64}$.109375	—	2.778
$\frac{1}{8}$.1250	—	3.175
$\frac{9}{64}$.140625	—	3.572
$\frac{5}{32}$.15625	—	3.969
$\frac{11}{64}$.171875	—	4.366
$\frac{3}{16}$.1875	—	4.763
$\frac{13}{64}$.203125	—	5.159
$\frac{7}{32}$.21875	—	5.556
$\frac{15}{64}$.234375	—	5.953
$\frac{1}{4}$.2500	—	6.350
$\frac{17}{64}$.265625	—	6.747
$\frac{9}{32}$.28125	—	7.144
$\frac{19}{64}$.296875	—	7.541
$\frac{5}{16}$.3125	—	7.938
$\frac{21}{64}$.328125	—	8.334
$\frac{11}{32}$.34375	—	8.731
$\frac{23}{64}$.359375	—	9.128
$\frac{3}{8}$.3750	—	9.525
$\frac{25}{64}$.390625	—	9.922
$\frac{13}{32}$.40625	—	10.319
$\frac{27}{64}$.421875	—	10.716
$\frac{7}{16}$.4375	—	11.113
$\frac{29}{64}$.453125	—	11.509
$\frac{15}{32}$.46875	—	11.906
$\frac{31}{64}$.484375	—	12.303
$\frac{1}{2}$.5000	—	12.700

1 mm = .03937"

DECIMALS MILLIMETERS

$\frac{33}{64}$.515625	—	13.097
$\frac{17}{32}$.53125	—	13.494
$\frac{35}{64}$.546875	—	13.891
$\frac{9}{16}$.5625	—	14.288
$\frac{37}{64}$.578125	—	14.684
$\frac{19}{32}$.59375	—	15.081
$\frac{39}{64}$.609375	—	15.478
$\frac{5}{8}$.6250	—	15.875
$\frac{41}{64}$.640625	—	16.272
$\frac{21}{32}$.65625	—	16.669
$\frac{43}{64}$.671875	—	17.066
$\frac{11}{16}$.6875	—	17.463
$\frac{45}{64}$.703125	—	17.859
$\frac{23}{32}$.71875	—	18.256
$\frac{47}{64}$.734375	—	18.653
$\frac{3}{4}$.7500	—	19.050
$\frac{49}{64}$.765625	—	19.447
$\frac{25}{32}$.78125	—	19.844
$\frac{51}{64}$.796875	—	20.241
$\frac{13}{16}$.8125	—	20.638
$\frac{53}{64}$.828125	—	21.034
$\frac{27}{32}$.84375	—	21.431
$\frac{55}{64}$.859375	—	21.828
$\frac{7}{8}$.8750	—	22.225
$\frac{57}{64}$.890625	—	22.622
$\frac{29}{32}$.90625	—	23.019
$\frac{59}{64}$.921875	—	23.416
$\frac{15}{16}$.9375	—	23.813
$\frac{61}{64}$.953125	—	24.209
$\frac{31}{32}$.96875	—	24.606
$\frac{63}{64}$.984375	—	25.003
1	1.000	—	25.400

.001" = .0254 mm

DISPLACEMENT CONVERSION FOR ENGINES

Liters	Cubic Inches	Liters	Cubic Inches
1.486	4.2258
1.696	4.3260
1.697	4.3262
1.697.6	4.3265
1.698	4.4267
1.7105	4.8292
1.8109.5	4.9300
1.8109.8	4.9301
2.0121	5.0302
2.0121.7	5.0304
2.0122	5.0305
2.2135	5.0307
2.3140	5.2318
2.5151	5.7345
2.6156	5.7350
2.6158.6	5.8351
2.8171	5.9360
2.8173	6.0368
3.0184	6.4390
3.2196	6.6400
3.2198	6.6401
3.3198.5	6.6403
3.3200	7.0425
3.7225	7.2440
3.8229	7.4454
3.8231	7.5455
3.8232	7.7460
4.0243	8.2500
4.1252		
4.2255		

Metric Conversion
mmx .03937 = inches

Replacement Tips for most popular Brake Lathes

Round tips yield more cutting edges per tip than traditional triangular tips

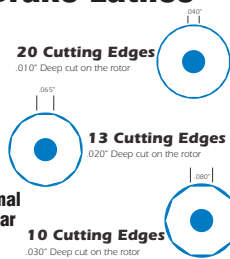

Visit us online anytime at www.goodtool-online.com

TAP DRILL SIZES

NATIONAL COARSE & FINE THREADS

THREAD	DRILL
1/4-20	NO. 8
1/4-28	NO. 3
5/16-18	F
5/16-24	I
3/8-16	5/16
3/8-24	Q
7/16-14	U
7/16-20	W
1/2-13	27/64
1/2-20	29/64
9/16-12	31/64
9/16-18	33/64
5/8-11	17/32
5/8-18	37/64
3/4-10	21/32
3/4-16	11/16
7/8-9	49/64
7/8-14	13/16

Check out our Double Duty Tip Holders - never search for another holder again!

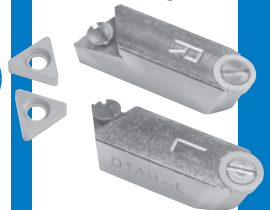

BRAKE LATHE REPLACEMENT PART HEADQUARTERS